

# 1090 Thomas Busch Memorial Highway Pennsauken, New Jersey

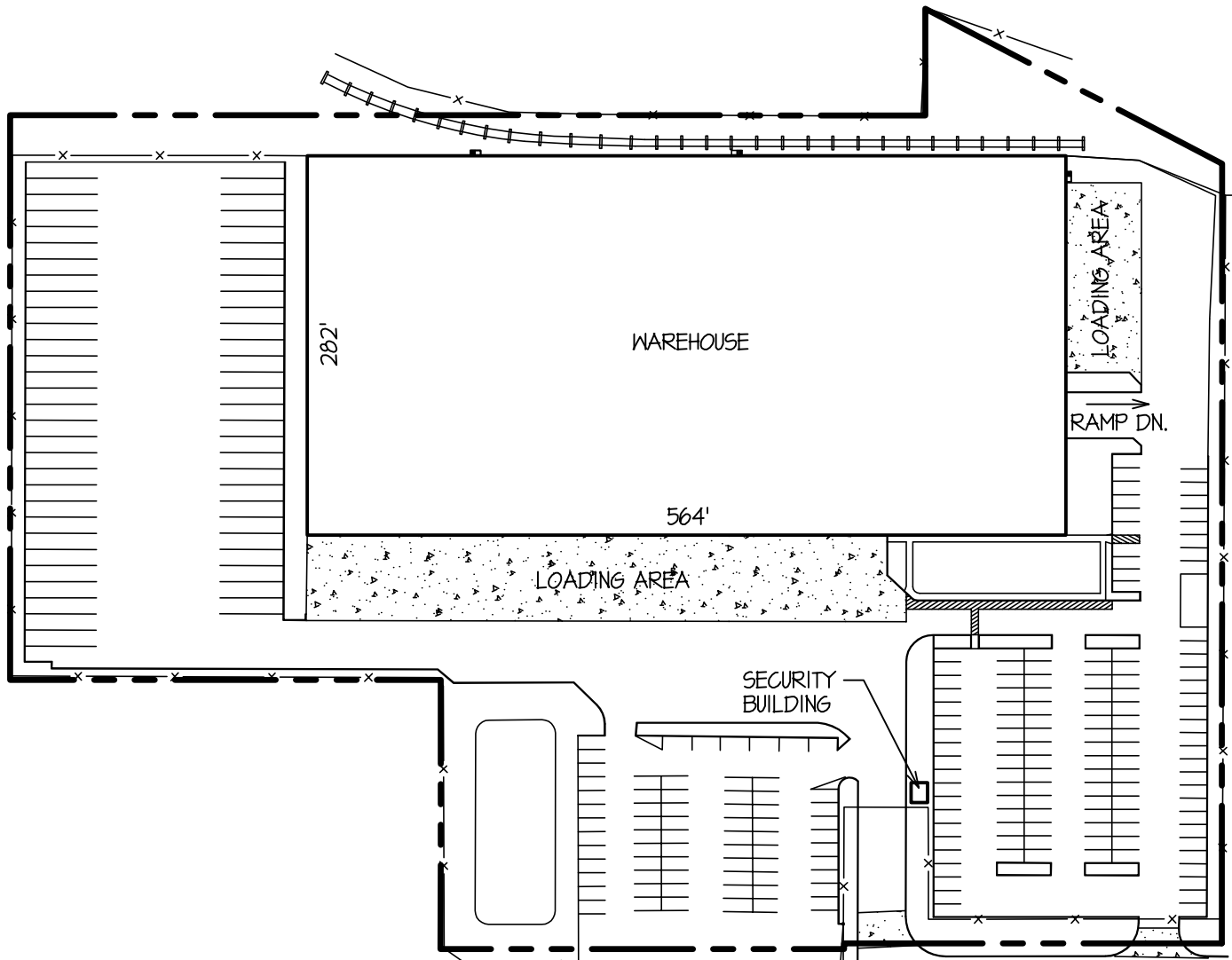

One Underwood Court, P.O. Box 1605  
Delran, New Jersey 08075-0117  
(856) 764-2600 -- Fax: (856) 764-9240  
E-mail: [marketing@whitesellco.com](mailto:marketing@whitesellco.com)  
[www.whitesellco.com](http://www.whitesellco.com)



**FEATURES:**

- 168,131 SQ. FT. : 19,500 SQ. FT. OFFICE (2 STORIES)  
149,237 SQ. FT. WAREHOUSE
- 38,400 SQ. FT. POSSIBLE FUTURE EXPANSION
- ELECTRIC SERVICE : 480/277V, 208/120V, 800 AMP
- GAS HEAT - OFFICE AIR CONDITIONED.
- CLEARANCE : 30'-1"
- (38) LOADING DOCK DOORS : 8'-0" x 9'-0"
- (13) DOCK LEVELERS: 6'-0" x 8'-0"
- (6) RAIL CAR LOADING DOCK DOORS: 10'-0" x 10'-0"
- (1) DRIVE-IN DOCK DOOR: 12'-0" x 14'-0"
- AVAILABLE CAR PARKING: 189 SPACES
- AVAILABLE TRAILER PARKING: 59 SPACES

THOMAS BUSCH MEMORIAL HIGHWAY



**Whitesell Construction Co. Inc.**

One Underwood Court  
Delran, New Jersey 08075  
(856) 764-2600

UNIT No.

SITE PLAN

DATE:

06/15/10

SCALE:

N.T.S.

1090 BUSCH MEMORIAL HWY.  
PENNSAUKEN, NEW JERSEY