

# 110 Mount Holly Bypass Lumberton, NJ



One Underwood Court, P.O. Box 1605  
Delran, New Jersey 08075-0117  
(856) 764-2600  
E-mail: [leasing@whitesellco.com](mailto:leasing@whitesellco.com)



One Underwood Court  
P.O. Box 1605 • Delran, NJ 08075  
Phone: 856-764-2600 Fax: 856-764-8963  
[leasing@whitesellco.com](mailto:leasing@whitesellco.com)

## **110 MOUNT HOLLY BY-PASS LUMBERTON, NEW JERSEY**

LOCATION: 110 Mount Holly Bypass  
Lumberton, New Jersey

BUILDING TYPE: Multi-Tenant Industrial Building.

SIZE: 84,564 square feet.

CLEAR HEIGHT: 30 feet.

BAY SIZE: 40' x 40'.

CONSTRUCTION: Steel frame, masonry with insulated metal panels.

ROOF TYPE: Rubber.

LOADING: 18 8' x 10' Dock Doors.  
2 12' x 12' Drive-In Doors.

POWER: 277/480 volts; 120/208 volts – 3 phase-2,000 amps.

HVAC: Gas heat.  
Office air conditioned.

FIRE PROTECTION: ESFR.

PARKING: 111 car parking spaces.

jp:9-12-11

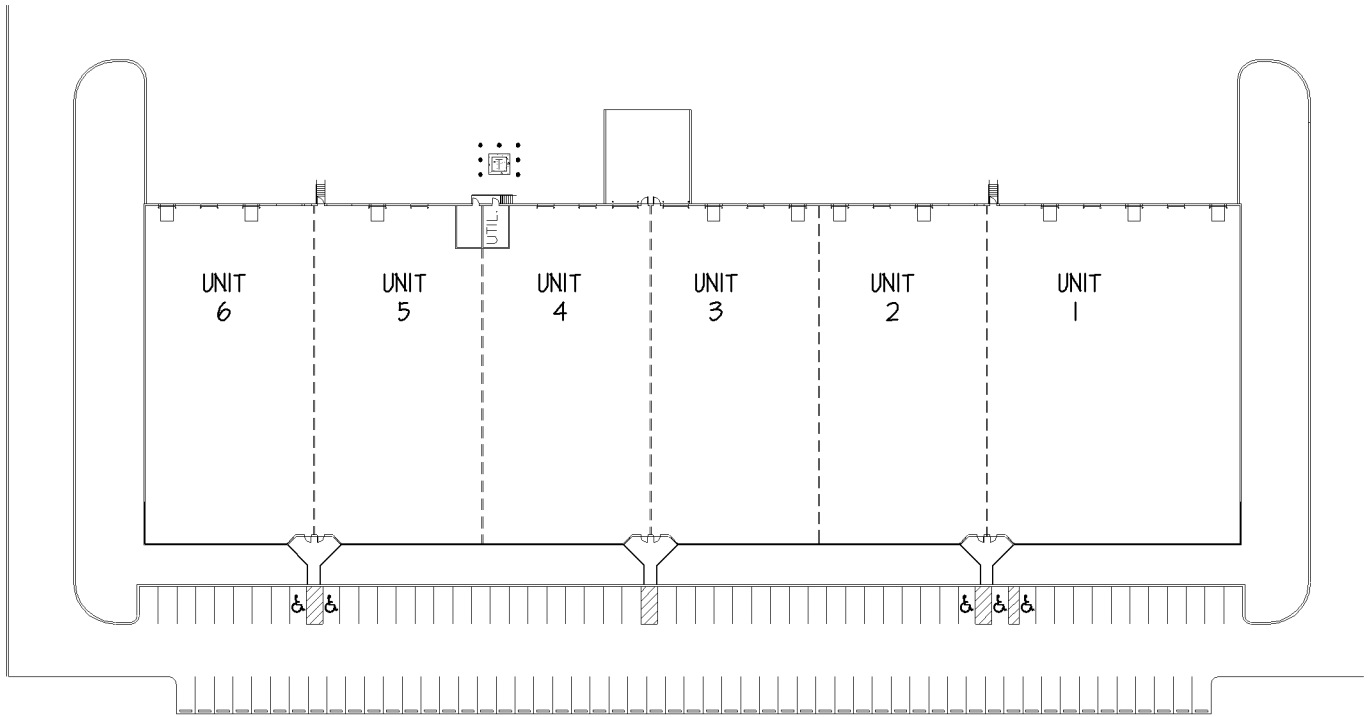

**FEATURES:**

- 84,564 SQ. FT. TOTAL
- ELECTRICAL SERVICE:
  - 277/480 VOLTS; 12/208 VOLTS;
  - 2000 AMPS; 3 PHASE
- MECHANICAL:
  - GAS HEAT
  - OFFICE AIR CONDITIONED
- TYPICAL STRUCTURAL BAY:
  - 40'-0" x 40'-0"
- CLEAR HEIGHT: 30'-6"
- (18) 8'-0" x 10'-0" DOCK DOORS
- (2) 12'-0" x 12'-0" DRIVE-IN DOORS
- III PARKING SPACES



**Whitesell Construction Co. Inc.**

One Underwood Court  
 Delran, New Jersey 08075  
 (856) 764-2600

UNIT No.	DATE:	SCALE:
OVERALL	04/05/11	N.T.S.

**110 MT. HOLLY BY-PASS  
 LUMBERTON, NEW JERSEY**