

# 1100 John Galt Way Florence, NJ



**One Underwood Court, P.O. Box 1605  
Delran, New Jersey 08075-0117  
(856) 764-2600  
E-mail: [leasing@whitesellco.com](mailto:leasing@whitesellco.com)**



One Underwood Court  
P.O. Box 1605 • Delran, NJ 08075  
Phone: 856-764-2600 Fax: 856-764-8963  
[leasing@whitesellco.com](mailto:leasing@whitesellco.com)

**1100 JOHN GALT WAY  
THE HAINES CENTER  
BURLINGTON/FLORENCE TOWNSHIP, NEW JERSEY**

LOCATION: 1100 John Galt Way  
Burlington, New Jersey

BUILDING TYPE: Multi-Tenant Industrial Building.

SIZE: 513,136 square feet.

CLEAR HEIGHT: Minimum 30 feet.  
Maximum 37 feet.

BAY SIZE: 40' x 60'

CONSTRUCTION: Steel frame, masonry structure with insulated metal panels.

ROOF TYPE: Rubber.

LOADING: 96 8' x 10' Dock Doors.  
4 12' x 14' Drive-In Door.

POWER: 480/277 volt; 3 phase; 3,000 amps.

HVAC: Gas heat.  
Office air conditioned.

FIRE PROTECTION: ESFR sprinkler system with fire pump.

PARKING: 95 car parking spaces.  
135 trailer spaces.

jp:9-12-11

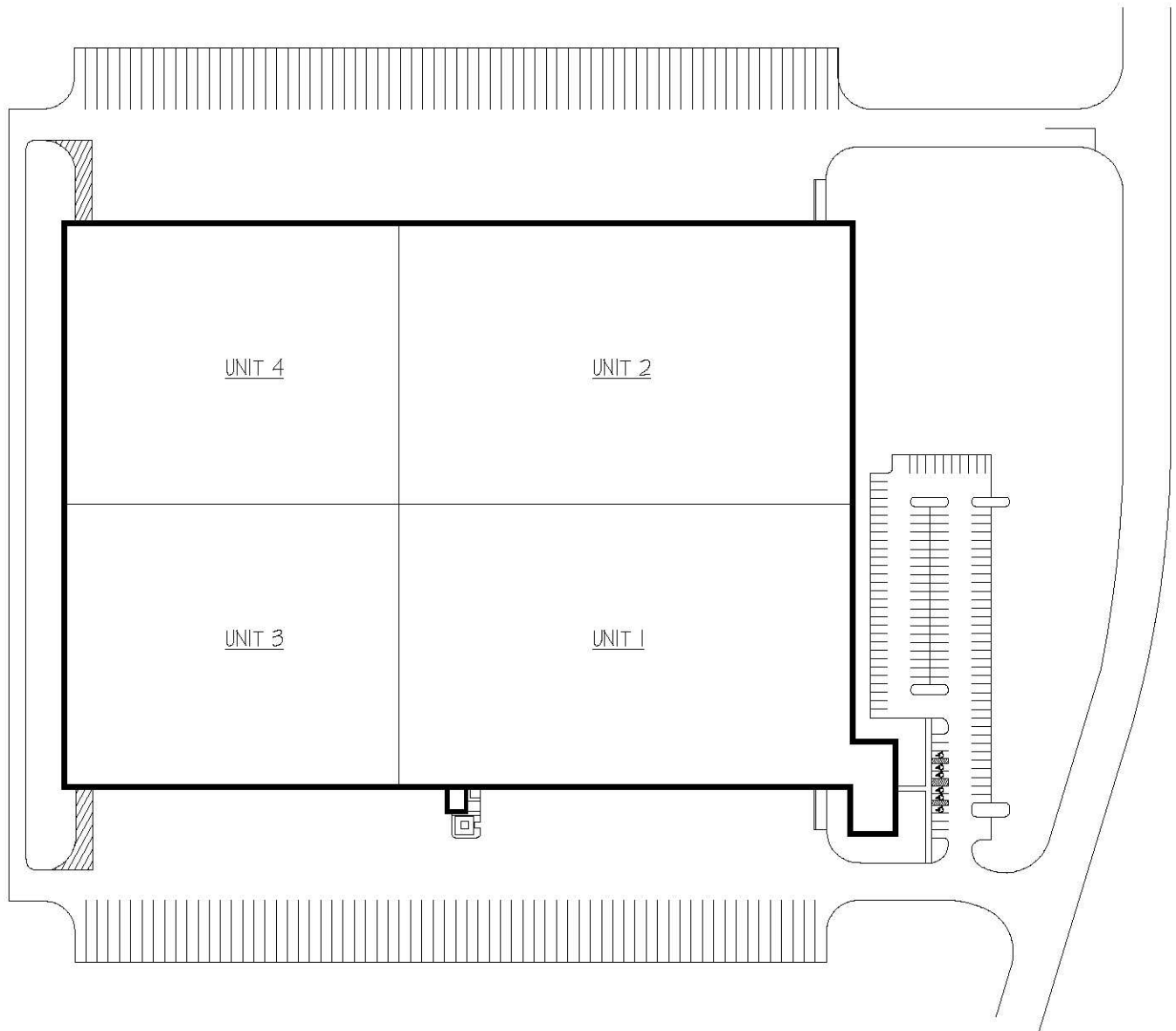

FEATURES:

- 513,136 SQ. FT. TOTAL
- PUBLIC WATER, SEWER & GAS
- (96) 8'-0" x 10'-0" DOCK DOORS
- (4) 12'-0" x 14'-0" DRIVE-IN DOORS
- (95) CAR PARKING SPACES
- (135) TRUCK PARKING SPACES
- CLEARANCE HEIGHT:  
MIN. = 30'-9"  
MAX. = 37'-0"



**Whitesell Construction Co. Inc.**

One Underwood Court  
Delran, New Jersey 08075  
(856) 764-2600

UNIT No.

SITE

DATE:

07/28/05

SCALE:

N.T.S.

**1100 JOHN GALT WAY  
FLORENCE, NEW JERSEY**