

3000 Cindel Drive Cinnaminson, New Jersey



One Underwood Court
Delran, New Jersey 08075-0117
(856) 764-2600
E-mail: leasing@whitesellco.com



One Underwood Court
P.O. Box 1605 • Delran, NJ 08075
Phone: 856-764-2600 Fax: 856-764-8963
leasing@whitesellco.com

3000 CINDEL DRIVE CINNAMINSON, NEW JERSEY

LOCATION: 3000 Cindel Drive
Cinnaminson, New Jersey

BUILDING TYPE: Single Tenant Industrial Building.

SIZE: 209,657 square feet.

CLEAR HEIGHT: 24' – 30'.

BAY SIZE: 40' x 40'.

CONSTRUCTION: Masonry with insulated metal panels.

ROOF TYPE: White Thermoplastic TPO Roof.

LOADING:

10	8' x 9'	Dock Doors.
10	9' x 10'	Dock Doors.
5	10' x 12'	Rail Doors.
1	12' x 14'	Drive-In Door.

POWER: 480/277V-3 phase-2,000 amps.

HVAC: Gas heat.
Office air conditioned.

FIRE PROTECTION: Ordinary Hazard Pipe Schedule.

PARKING: 257 car parking spaces.

jp:7-13-11

BROAD STREET (RIVER ROAD)

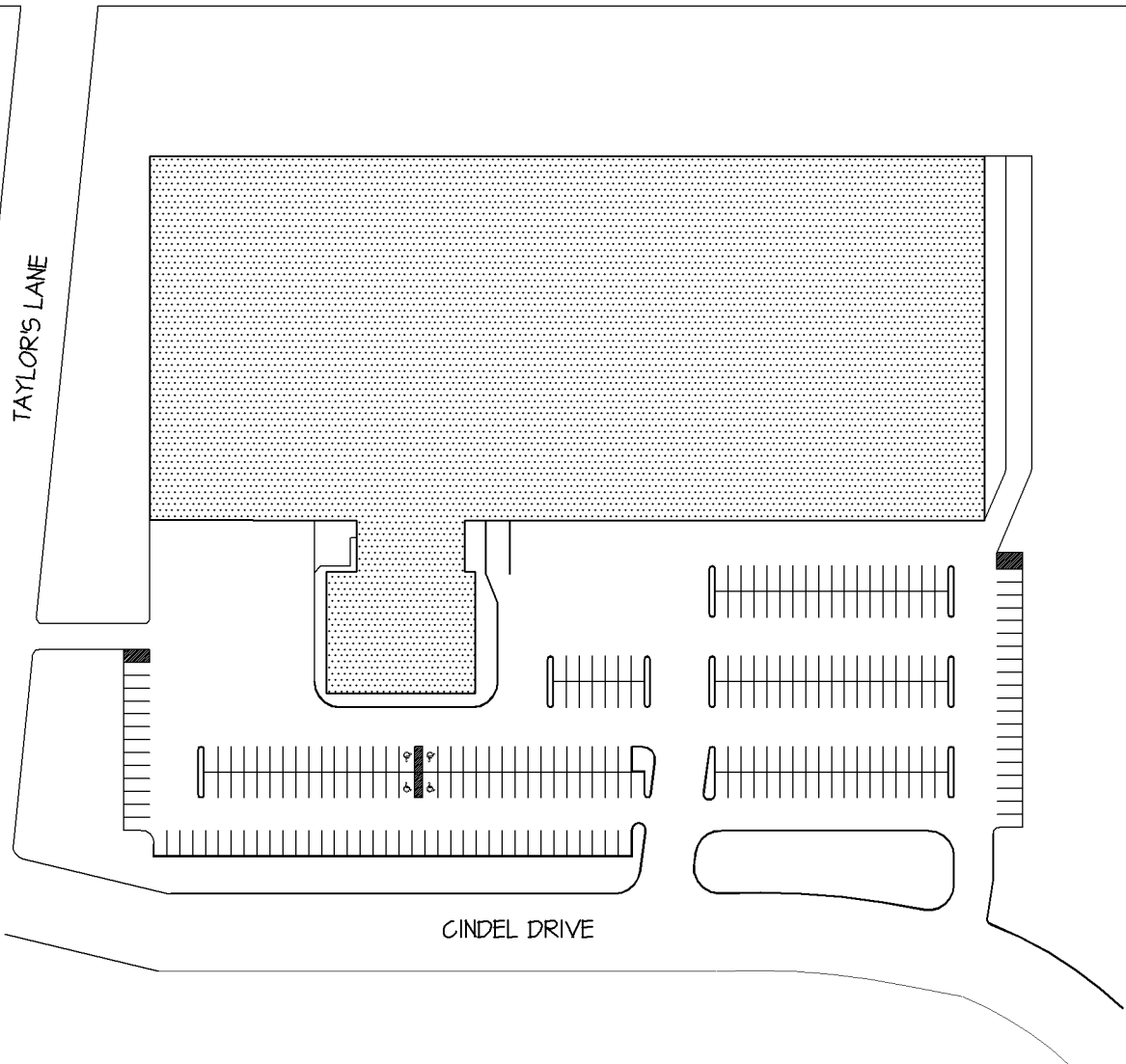

FEATURES:

- 209,657 SQ. FT. TOTAL
 - FIRST FLOOR OFFICE: - 16,462 SQ. FT.
 - WAREHOUSE: - 180,200 SQ. FT.
- SECOND FLOOR OFFICE: - 10,810 SQ. FT.
- WAREHOUSE MEZZANINE: - 2,185 SQ. FT.
- ELECTRICAL SERVICE:
 - 480/277 VOLTS-3 PHASE-2000 AMPS TRANSFORMED TO 120/208 VOLTS
- MECHANICAL SERVICE:
 - GAS HEAT
 - OFFICE AIR CONDITIONED
- TYPICAL STRUCTURAL BAY:
 - 40'-0" x 40'-0"
- (10) 8'-0" x 9'-0" DOCK DOORS
- (10) 9'-0" x 10'-0" DOCK DOORS
- (5) 10'-0" x 12'-0" RAIL DOORS
- (1) 12'-0" x 14'-0" DRIVE-IN DOOR
- 257 PARKING SPACES
- CLEARANCE HEIGHT:
 - MIN. = 24'-3"
 - MAX. = 30'-1"



Whitesell Construction Co. Inc.

One Underwood Court
Delran, New Jersey 08075
(856) 764-2600

UNIT No.

SITE PLAN

DATE:

04/28/11

SCALE:

NTS

**3000 CINDEL DRIVE
CINNAMINSON TOWNSHIP
BURLINGTON COUNTY, NEW JERSEY**