

8 Berry Drive Hainesport, NJ



**One Underwood Court, P.O. Box 1605
Delran, New Jersey 08075-0117
(856) 764-2600
E-mail: leasing@whitesellco.com**



One Underwood Court
P.O. Box 1605 • Delran, NJ 08075
Phone: 856-764-2600 Fax: 856-764-8963
leasing@whitesellco.com

8 BERRY DRIVE HAINESPORT, NEW JERSEY

LOCATION: Burlington County Business Center
8 Berry Drive
Hainesport, New Jersey

BUILDING TYPE: Single Tenant Industrial Building.

SIZE: 162,299 square feet.

CLEAR HEIGHT: Minimum 30'-0" feet.
Maximum 33'-9" feet.

BAY SIZE: 40' x 60'.

CONSTRUCTION: Steel frame and masonry with insulated metal panels.

ROOF TYPE: Rubber.

LOADING: 16 8' x 10' Dock Doors.
2 12' x 14' Drive-In Doors.
44 8' x 10' Knockouts

POWER: 277/480V; 120/208V; 3 phase; 2000 amps.

HVAC: Gas heat.
Office air conditioned.

FIRE PROTECTION: ESRF.

PARKING: 91 car parking spaces.

jw:3-1-12

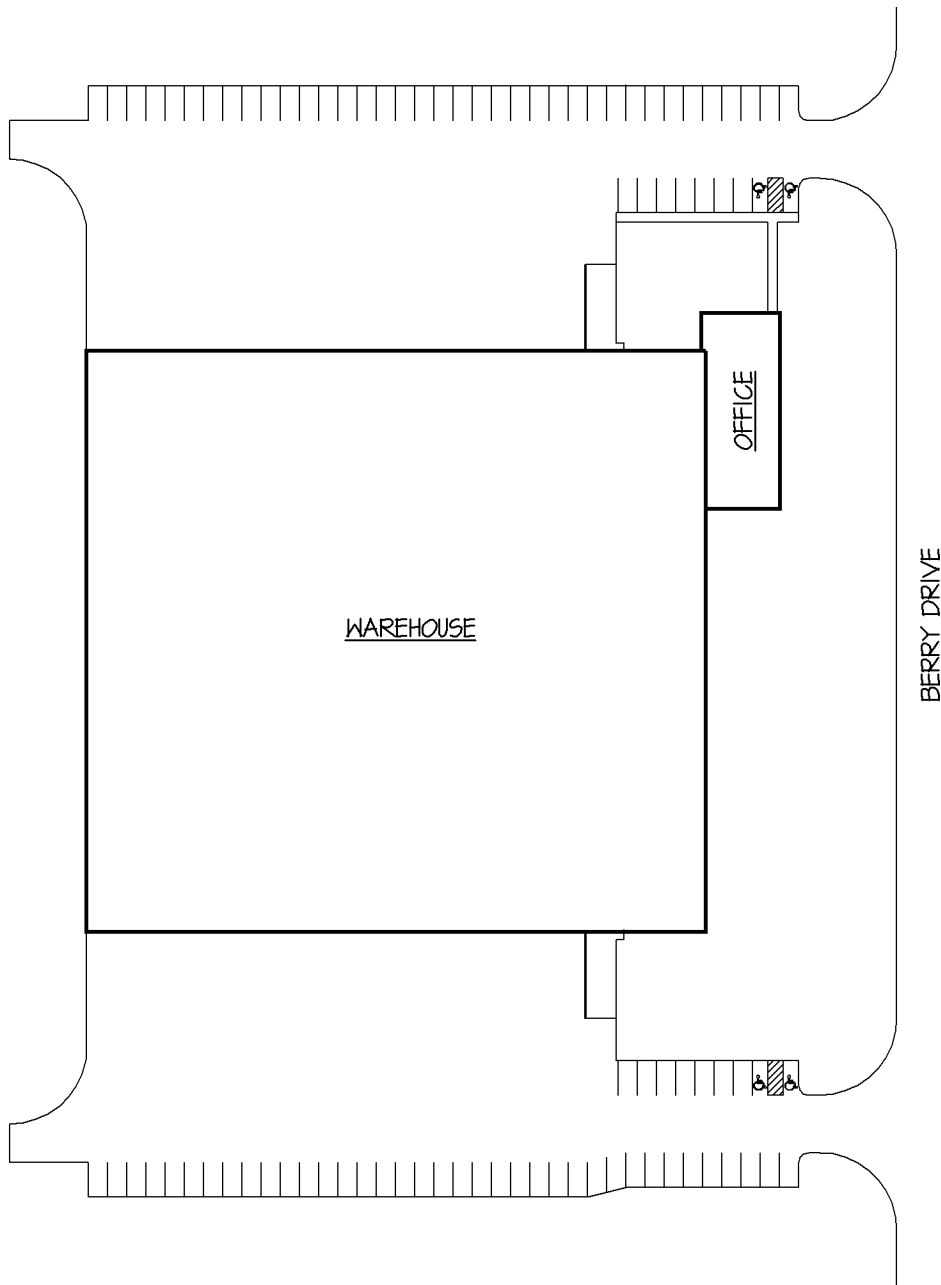

FEATURES:

- 162,299 SQ. FT. TOTAL
- PUBLIC WATER, SEWER & GAS
- CLEAR HEIGHT: VARIES FROM 33'-4" TO 30'-0"
- (16) 8'-0" x 10'-0" DOCK DOORS
- (2) 12'-0" x 14'-0" DRIVE-IN DOORS
- (44) 8'-0" x 10'-0" KNOCKOUTS
- 91 PARKING SPACES



Whitesell Construction Co. Inc.

One Underwood Court
 Delran, New Jersey 08075
 (856) 764-2600

UNIT No.

SITE

DATE:

03/01/12

SCALE:

N.T.S.

**8 BERRY DRIVE
 HAINESPORT, NEW JERSEY**