

# 140 Mount Holly Bypass Lumberton, NJ

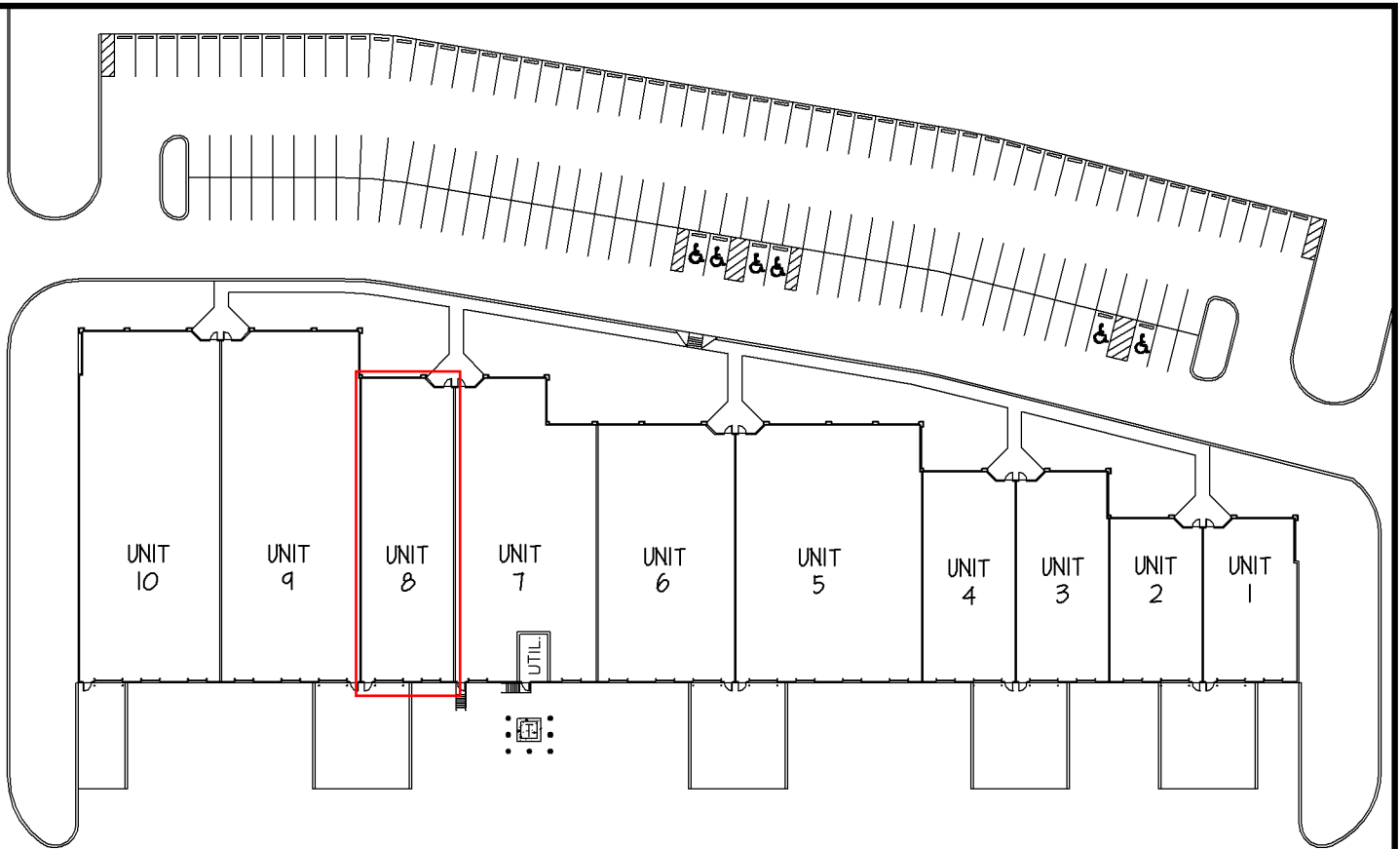

**One Underwood Court, P.O. Box 1605  
Delran, New Jersey 08075-0117  
(856) 764-2600  
E-mail: [leasing@whitesellco.com](mailto:leasing@whitesellco.com)**



**FEATURES:**

- 59,291 SQ. FT. TOTAL
- ELECTRICAL SERVICE:
  - 480/277 VOLTS; 3 PHASE; 2,500 AMPS
  - 208/120 VOLTS
- MECHANICAL SERVICE:
  - GAS HEAT
  - OFFICE AIR CONDITIONED
- TYPICAL STRUCTURAL BAY:
  - 40'-0" x 40'-0"
- CLEAR HEIGHT: VARIES BY UNIT
- (16) 8'-0" x 10'-0" DOCK DOORS
- (9) 12'-0" x 12'-0" DRIVE-IN DOORS
- PUBLIC WATER & SEWER
- 150 PARKING SPACES
- ZONING: I-2 (PLANNED INDUSTRIAL)

**UNIT AREAS:**

- UNIT 1 - 2,890 S.F.
- UNIT 2 - 2,845 S.F.
- UNIT 3 - 3,642 S.F.
- UNIT 4 - 3,649 S.F.
- UNIT 5 - 8,901 S.F.
- UNIT 6 - 6,799 S.F.
- UNIT 7 - 6,998 S.F.
- UNIT 8 - 5,259 S.F.
- UNIT 9 - 9,087 S.F.
- UNIT 10 - 9,221 S.F.



**Whitesell**

One Underwood Court, Delran, New Jersey 08075  
 Phone: (856) 764-2600 Web: www.whitesellco.com

UNIT No.

SITE

DATE:

03/16/15

SCALE:

1" = 80'

**140 MT. HOLLY BY-PASS  
 LUMBERTON, NEW JERSEY**

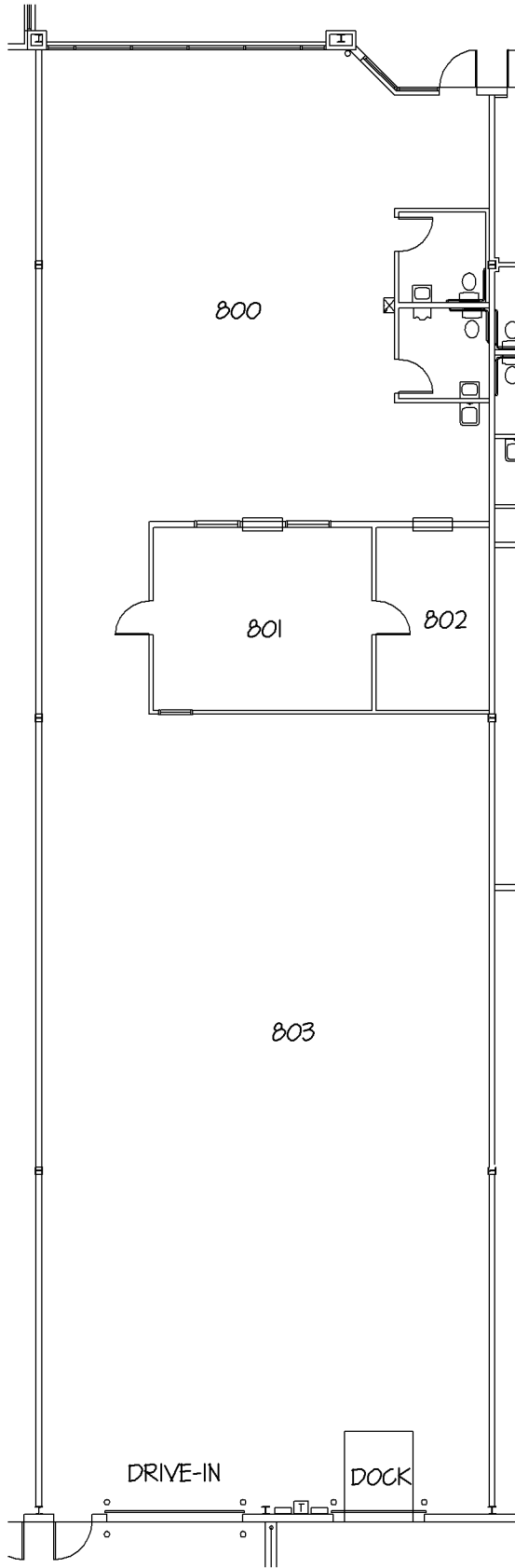

**FEATURES:**

- 5,259 SQ. FT. TOTAL
- ELECTRICAL SERVICE:
  - 120/208 VOLTS
  - 277/480 VOLTS
  - 3 PHASE; 200 AMPS
- MECHANICAL:
  - GAS HEAT
  - OFFICES A.C. WALL UNITS
- TYPICAL STRUCTURAL BAY:
  - 40'-0" x 40'-0"
- (1) 8'-0" x 10'-0" DOCK DOOR
- (1) 10'-0" x 12'-0" DRIVE-IN DOOR
- CLEARANCE HEIGHT:
  - MIN. = 19'-0"
  - MAX. = 22'-4"

**APPROX. ROOM SIZES:**

- 800- 41'-8" x 39'-6"
- 801 - 16'-2" x 19'-4"
- 802- 16'-2" x 10'-0"
- 803- 70'-8" x 39'-6"



**Whitesell Construction Co. Inc.**

One Underwood Court  
 Delran, New Jersey 08075  
 (856) 764-2600

UNIT No.

UNIT 8

DATE:

06/24/14

SCALE:

NO SCALE

**140 MT. HOLLY BY-PASS  
 LUMBERTON, NEW JERSEY**