

**1815 Route 130
Burlington, NJ**

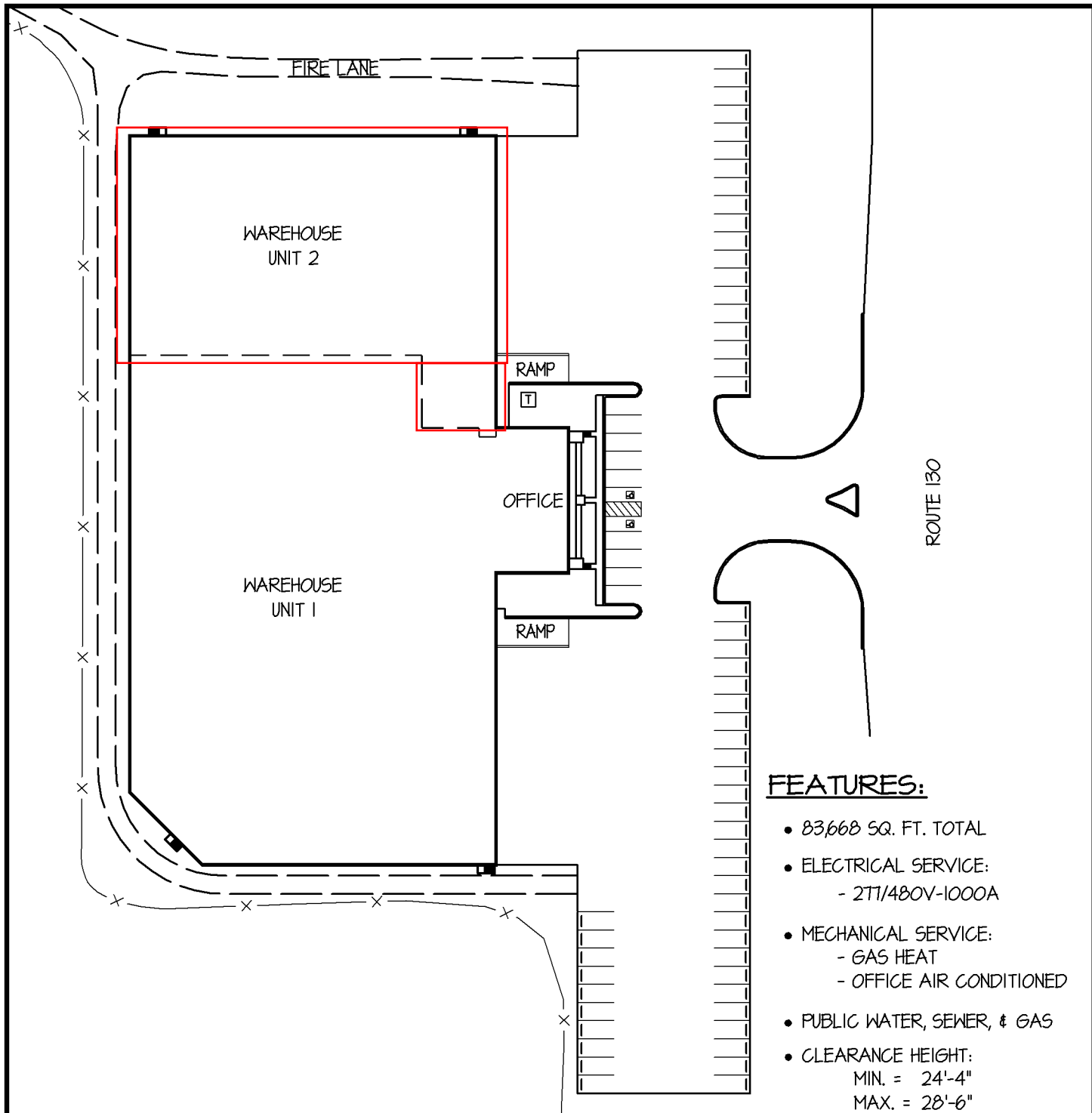

**One Underwood Court, P.O. Box 1605
Delran, New Jersey 08075-0117
(856) 764-2600
E-mail: leasing@whitesellco.com**



FEATURES:

- 83,668 SQ. FT. TOTAL
- ELECTRICAL SERVICE:
- 2T/480V-1000A
- MECHANICAL SERVICE:
- GAS HEAT
- OFFICE AIR CONDITIONED
- PUBLIC WATER, SEWER, & GAS
- CLEARANCE HEIGHT:
MIN. = 24'-4"
MAX. = 28'-6"
- (18) 8'-0" x 10'-0" DOCK DOOR
- (2) 10'-0" x 12'-0" DRIVE-IN DOOR
- 66 PARKING SPACES

APPROX. UNIT SIZES:

- UNIT # 1 - 57,109 SQ. FT.
- UNIT # 2 - 25,959 SQ. FT.



Whitesell Construction Co. Inc.
 One Underwood Court
 Delran, New Jersey 08075
 (609) 764-2600

| | | | |
|--|------|-------------------|------------------|
| UNIT No. | SITE | DATE: 05/06/15 | SCALE: N.T.S. |
| 1815 ROUTE 130 BURLINGTON, NEW JERSEY | | | |

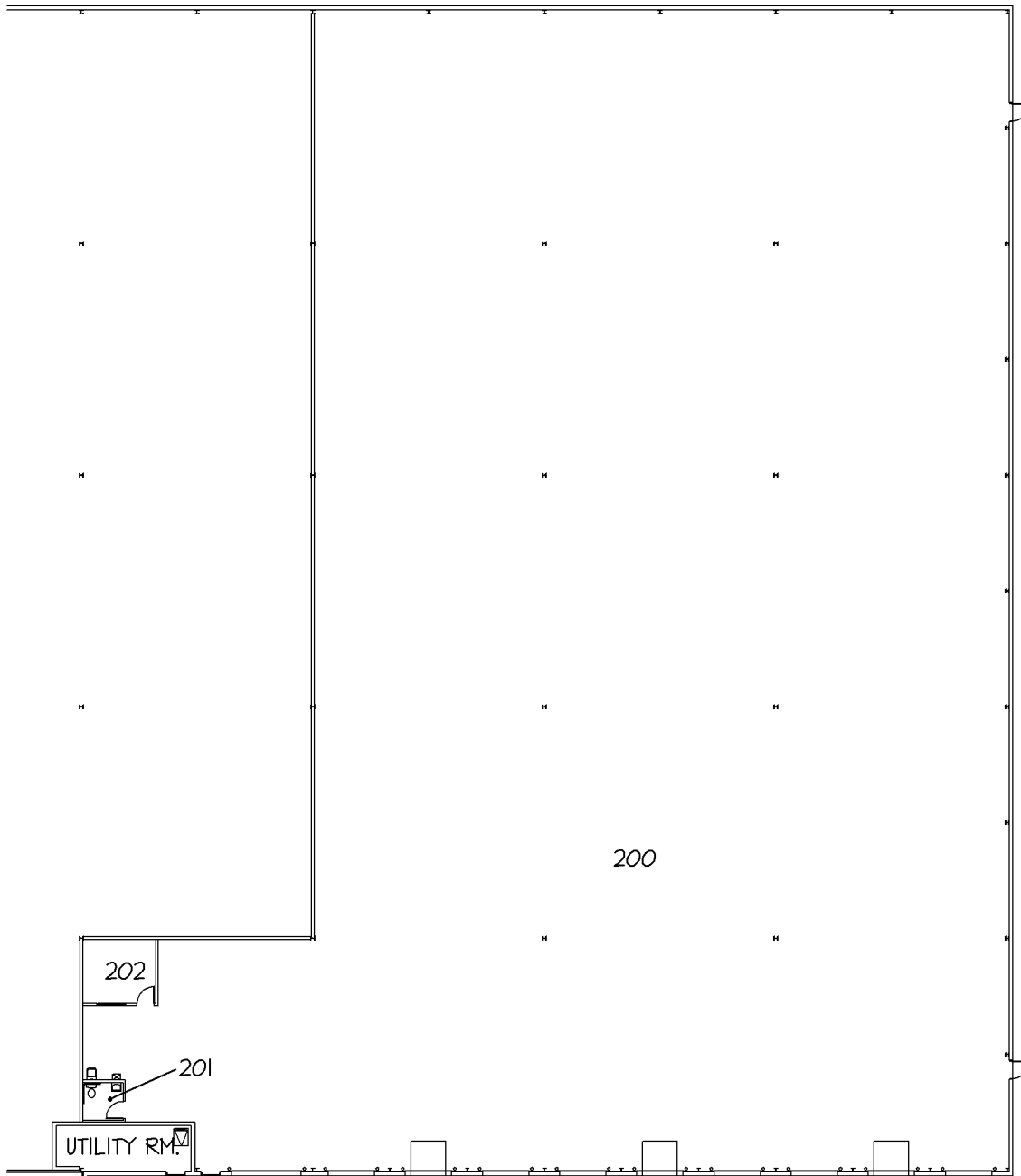

200

202

201

UTILITY RM.

RAMP
DN.

FEATURES:

- 25,959 SQ. FT.
- ELECTRIC SERVICE :
- 277/480V-400A
- MECHANICAL SERVICE:
- GAS HEAT
- OFFICE AIR CONDITIONED
- (9) 8'-0" x 10'-0" DOCK DOOR
- (1) 10'-0" x 12'-0" DRIVE-IN DOOR

- CLEARANCE HEIGHT:
MIN. = 24'-4"
MAX. = 28'-6"

APPROX. ROOM SIZES:

- 200-119'-5" x 200'-0"
- 201 -7'-0" x 6'-6"
- 202 -13'-0" x 11'-4"



Whitesell Construction Co. Inc.

One Underwood Court
Delran, New Jersey 08075
(609) 764-2600

| | | |
|---------------------------|--------------------------|----------------------------|
| UNIT No. UNIT 2 | DATE: 05/05/15 | SCALE: 1"=40'-0" |
|---------------------------|--------------------------|----------------------------|

**1815 ROUTE 130
BURLINGTON, NEW JERSEY**